



HIGH & LOW SELF-CONTAINED SLIDING GLASS DOOR BACKBAR REFRIGERATORS

Project _____

Dealer _____

Item # _____ Quantity _____

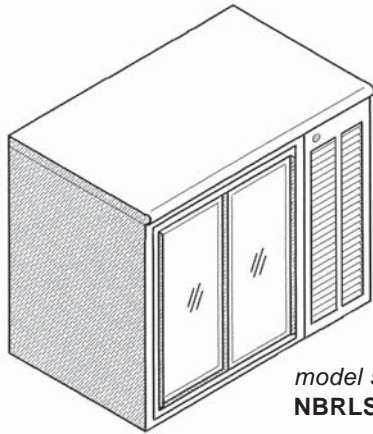

model shown:
NBRLS-SC1-38-RE-ST

optional right end utility
stub out & stainless top

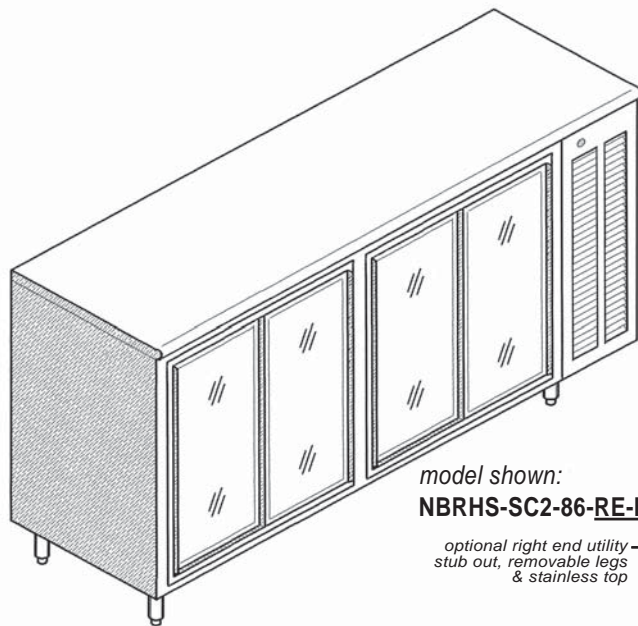

model shown:
NBRHS-SC2-86-RE-RL-ST

optional right end utility
stub out, removable legs
& stainless top

SPECIFICATION

ELECTRICAL:

115volts, 60 Hz, 1 phase AC.
AMP: 15A MAX (on all Self Contained units)

REFRIGERATION:

R22, Adjustable temperature control



NOMENCLATURE

NBR S-SC - - - (other options)

height:
L - 32" high apron
H - 37" high apron

Sizes:
1 - 38 = 1 sliding glass door set - 38"
1 - 62 = 1 sliding glass door set - 62"
2 - 86 = 2 sliding glass door sets - 86"
2 - 110 = 2 sliding glass door sets - 110"

Condenser Location:
(from left to right)
LE - left end
RE - right end

MODELS

model #	length
<input type="checkbox"/> NBRHS-SC1-38	38"
<input type="checkbox"/> NBRHS-SC1-62	62"
<input type="checkbox"/> NBRHS-SC2-86	86"
<input type="checkbox"/> NBRHS-SC2-110	110"
<input type="checkbox"/> NBRLS-SC1-38	38"
<input type="checkbox"/> NBRLS-SC1-62	62"
<input type="checkbox"/> NBRLS-SC2-86	86"
<input type="checkbox"/> NBRLS-SC2-110	110"

STANDARD FEATURES

- 18 gauge 304 stainless
- Wire racks
- Galvanized subtop & sides
- Foam in place insulation
- Epoxy coated evaporator coil
(refrigeration components field installed)
- Compressor / condensing unit
- Temperature Control
- Condensate evaporator pan
- Louvered access panel
- Standard operating temperature of 38° F

OPTIONAL FEATURES

model #	description
<input type="checkbox"/> ST	stainless top
<input type="checkbox"/> SSS	s/s sides (left & right)
<input type="checkbox"/> KC	keg conversion
<input type="checkbox"/> DPD	built in drain pan (adds additional 1" to ref. height)
<input type="checkbox"/> DL	door locks
<input type="checkbox"/> LT	lights
<input type="checkbox"/> FC (w/ 404A TEX valve).....	freezer conversion
<input type="checkbox"/> T28	28° F (chiller)
<input type="checkbox"/> T48	48° F (white wine)
<input type="checkbox"/> T58	58° F (red wine)
<input type="checkbox"/> RL	6" high removable legs
<input type="checkbox"/> CST35	3.5" high casters
<input type="checkbox"/> CU	4" high stainless curb
<input type="checkbox"/> DTC	digital temp. control
<input type="checkbox"/> M	modified size

*see options section for more details

NATIONAL BAR SYSTEMS

Phone: (714) 848-1688

16571 Burke Lane Huntington Beach, CA 92647

Fax: (714) 848-2788

Website: www.nbsmfg.com



HIGH & LOW SELF-CONTAINED SLIDING GLASS DOOR BACKBAR REFRIGERATORS

model shown:

NBRHS-SC1-38-RE-ST

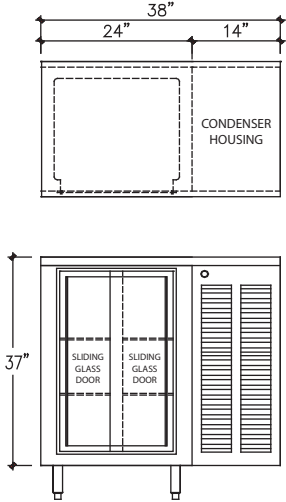

model shown:

NBRHS-SC1-62-RE-ST

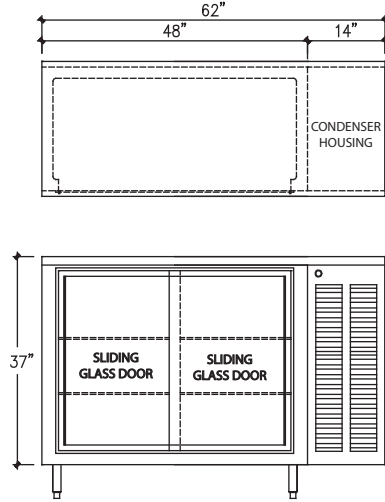

model shown:

NBRLS-SC2-86-RE-ST

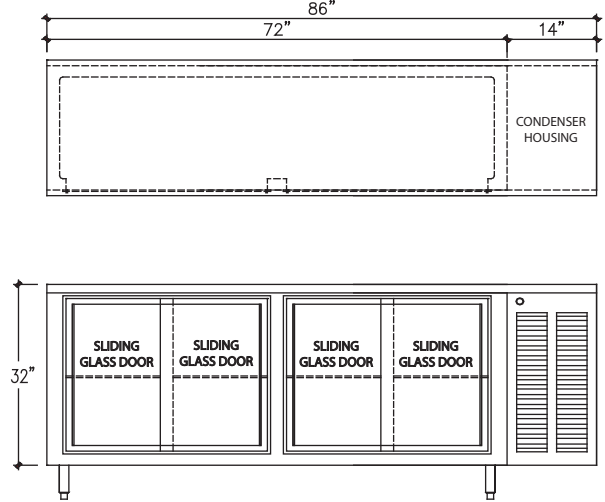

model shown:

NBRLS-SC2-110-RE-ST

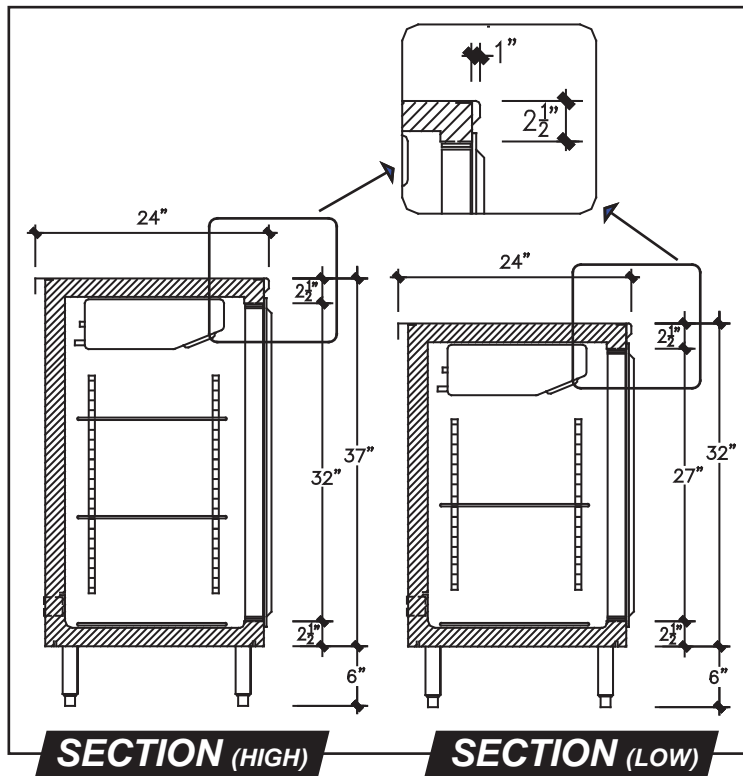
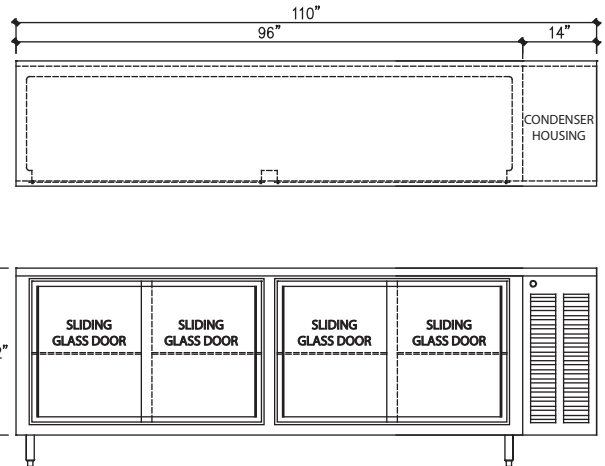

TECHNICAL DATA			
model #	length	shipping weight(lbs.)	no. of sliding doors
High			
NBRHS-SC1-38	38"	225	2
NBRHS-SC1-62	62"	275	2
NBRHS-SC2-86	86"	300	4
NBRHS-SC2-110	110"	325	4
Low			
NBRLS-SC1-38	38"	200	2
NBRLS-SC1-62	62"	250	2
NBRLS-SC2-86	86"	270	4
NBRLS-SC2-110	110"	300	4