



CORNER FILLER SECTIONS INSIDE CORNERS WITH FLAT TOP

Project _____

Dealer _____

Item # _____ Quantity _____

PRO-LINE

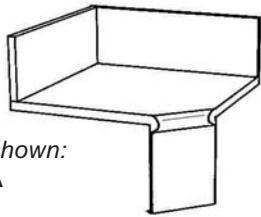

model shown:
NPFP-A

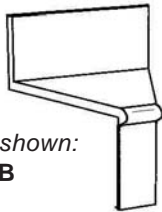

model shown:
NPFP-B

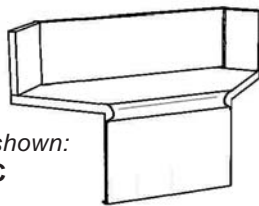

model shown:
NPFP-C

PRO-LINE SERIES 20" DEEP

model # (for different sizes call) length

NPFP-A-(a)-(b)-(c)-(d).....60"

NPFP-B-(a)-(b).....72"

NPFP-C-(a)-(b)-(c)-(d).....84"

*See reverse for dimension locations

CUSTOM SERIES 24" DEEP

model # (for different sizes call) length

NCFP-A-(a)-(b)-(c)-(d).....60"

NCFP-B-(a)-(b).....72"

NCFP-C-(a)-(b)-(c)-(d).....84"

*See reverse for dimension locations

STANDARD FEATURES

- 18 gauge #304 stainless
- Bullnose front design
- Seamless tops, drainboards pitched to sinks
- 6" High back splash

OPTIONAL FEATURES

- | model # | description |
|---|-----------------------|
| <input type="checkbox"/> APR (removable)..... | hinged apron frnt pnl |
| <input type="checkbox"/> M..... | modified size |
| <input type="checkbox"/> SP__ (4", 8", 10", 12")..... | high splash upg. |

CUSTOM

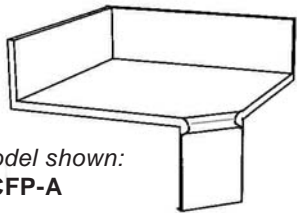

model shown:
NCFP-A

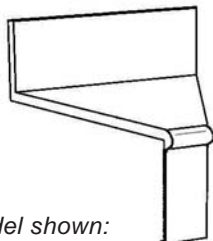

model shown:
NCFP-B

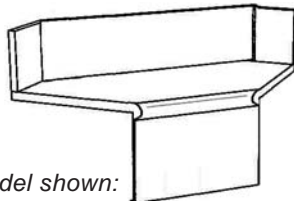

model shown:
NCFP-C



*see options section for more details

NATIONAL BAR SYSTEMS

16571 Burke Lane Huntington Beach, CA 92647

Phone: (714) 848-1688

Fax: (714) 848-2788

Website: www.nbsmfg.com

PRO-LINE

CUSTOM

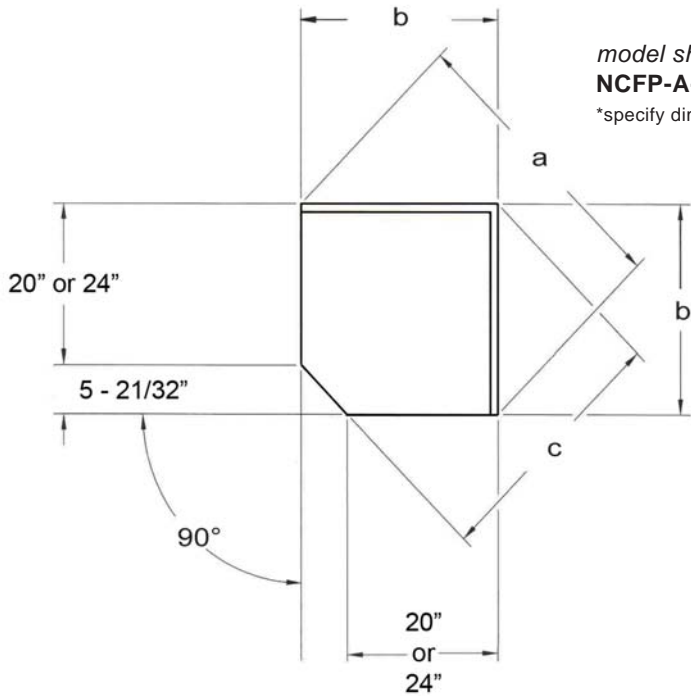

model shown:
NCFP-A-(a)-(b)-(c)-(d)
*specify dimensions when ordering

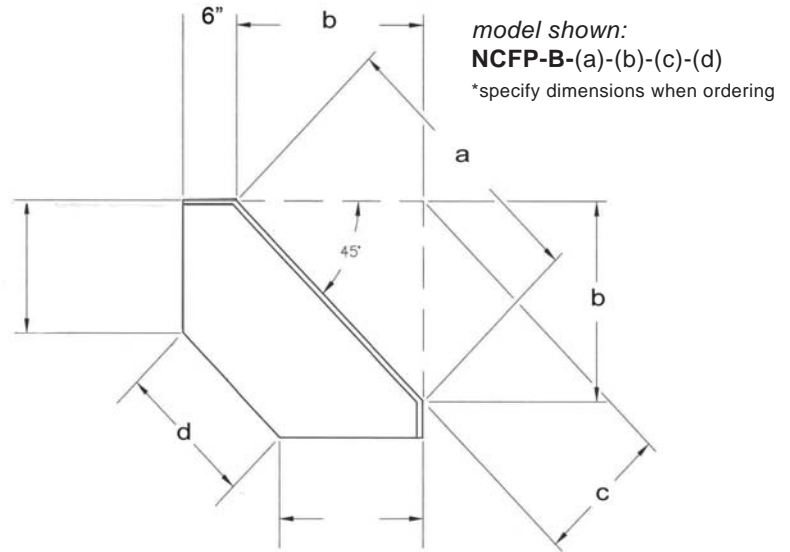

model shown:
NCFP-B-(a)-(b)-(c)-(d)
*specify dimensions when ordering

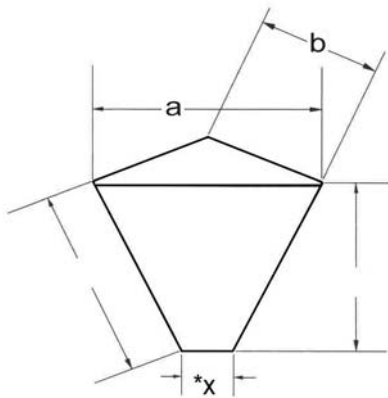

model shown:
NCFP-C-(a)-(b)
*specify dimensions when ordering

*CUSTOM-SIZE AND SHAPE AS SHOWN ON THE PLAN.

TECHNICAL DATA

model #	approximate shipping weight (lbs.)
NCFP-A-	30
NCFP-B-	30
NCFP-C-	30
NPFP-A-	30
NPFP-B-	30
NPFP-C-	30