

WALL MOUNT

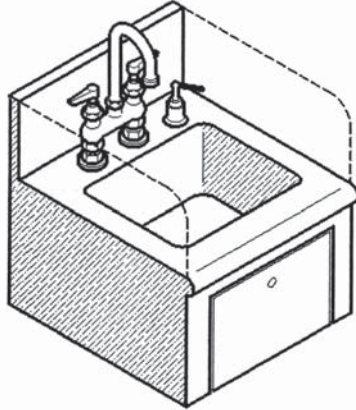

model shown:
NHS-1
(NHS-1E - w/o side splashes)

DROP-IN

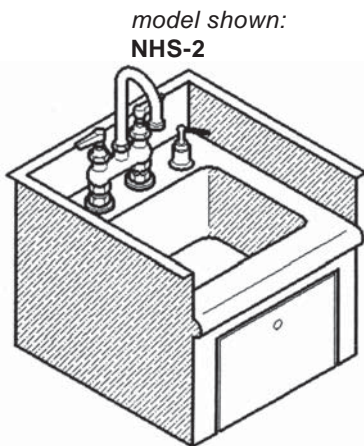

model shown:
NHS-2

12" WALL MOUNT

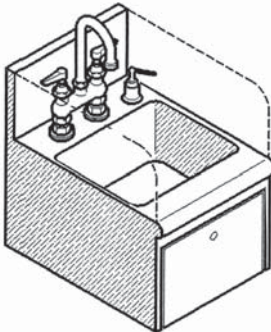

model shown:
NHS-3
(NHS-3E - w/o side splashes)

CABINET HAND SINK

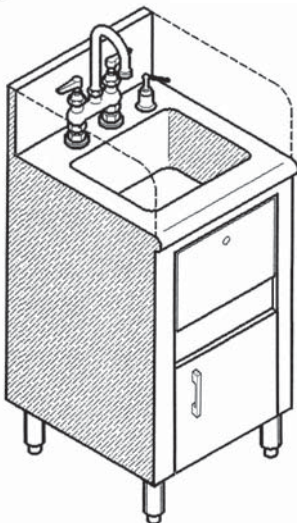

model shown:
NHS-1-CB
optional cabinet base
(NHS-1E-CB - w/o side splashes)

SPECIFICATIONS

PLUMBING:

- 1/2" cold and hot connections
- 1-1/2" stainless steel drain connection

Project _____

Dealer _____

Item # _____ Quantity _____

HAND SINKS

model #	length
<input type="checkbox"/> NHS-1 (wall mount).....	15"
<input type="checkbox"/> NHS-1E (economy wall mount).....	15"
<input type="checkbox"/> NHS-2 (drop-in).....	16"
<input type="checkbox"/> NHS-3 (wall mount).....	12"
<input type="checkbox"/> NHS-3E (economy wall mount).....	15"
<input type="checkbox"/> NHS-1-CB (cabinet stand alone).....	15"
<input type="checkbox"/> NHS-1E-CB (economy cabinet stand alone)....	15"

STANDARD FEATURES

- 18 gauge #304 stainless
- Bullnose front design
- Seamless tops pitched to sinks
- Towel dispenser
- Soap dispenser
- Low lead certified goose neck deck faucet
- Wall mount bracket
- 6" High left, right & back splashes
- 4" High left, right & back splashes (drop-in NHS-2)
- 10 x 11.75 stainless steel sink bowl
(NHS-1, NHS-1-CB & NHS-2)
- 8 x 10 stainless steel sink bowl (NHS-3)

OPTIONAL FEATURES

model #	description
<input type="checkbox"/> CF (low lead certified).....	Chicago faucet upg.
<input type="checkbox"/> SF (low lead certified).....	stainless steel faucet upg.
<input type="checkbox"/> CB	cabinet base
<input type="checkbox"/> APR (removable).....	hinged apron frnt pnl
<input type="checkbox"/> SHC (for Custom series 24").....	rear spacer Custom
<input type="checkbox"/> SHP (for Pro-Line series 20").....	rear spacer Pro-line
<input type="checkbox"/> SP __(4", 8", 10", 12").....	high splash upg.
<input type="checkbox"/> CFGB	battery electric faucet
<input type="checkbox"/> CFGP	plug electric fct
<input type="checkbox"/> CFGW	hardwire elect fct
<input type="checkbox"/> DUP (used w/ -cfgw).....	duplex add on
<input type="checkbox"/> QUP (used w/ -cfgw).....	quad-plex add on
<input type="checkbox"/> M	modified size
<input type="checkbox"/> LG	4x stainless stl. legs
<input type="checkbox"/> BLS	blender shlf add on
<input type="checkbox"/> FPV	foot pedal valve

*see options section for more details

**NHS-1
(WALL MOUNT)**



**NHS-3
(12" WALL MOUNT)**



**NHS-2
(DROP-IN)**



**NHS-1-CB
(CABINET HAND SINK)**

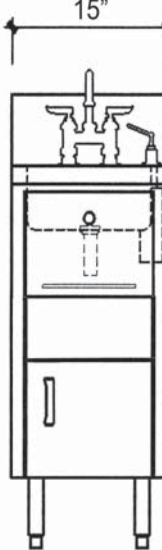
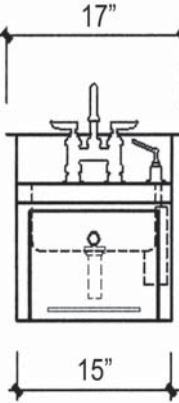
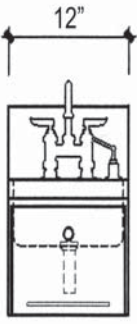
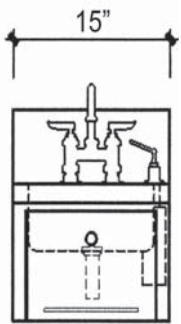

TECHNICAL DATA

model #	shipping weight (lbs.)
NHS-1	50
NHS-1E	45
NHS-2*	50
NHS-3	50
NHS-3E	45
NHS-1-CB	100
NHS-1E-CB	95

***NOTE:** Drop-in cutout size
 - left to right: 15 1/8"
 - front to back: 16 1/8"
 - top to bottom: 18"

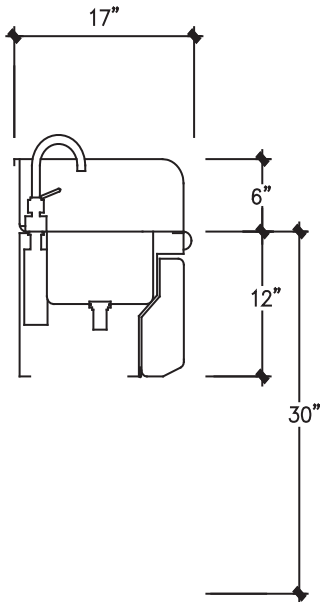

SECTION (WALL MOUNT)

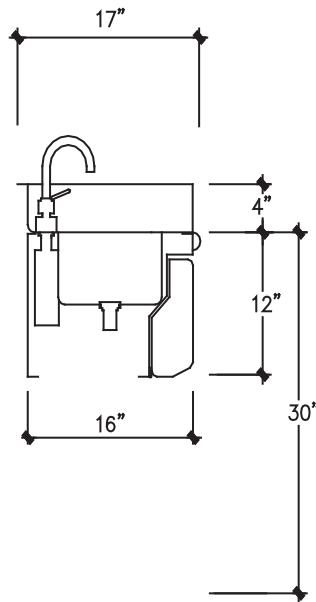

SECTION (DROP-IN)

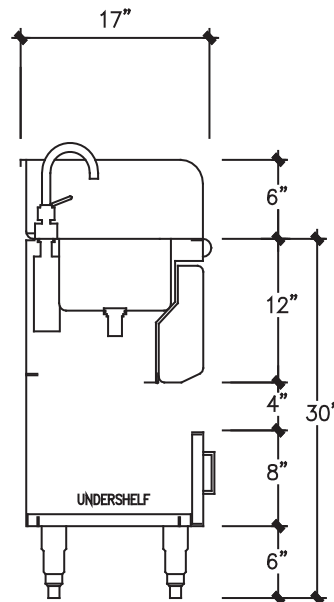

SECTION (CABINET)